

# ACM200 Capacitance Manometer



## Type ACM200

## ACM200 Capacitance Manometer

ACM Series are part of the Atovac family of general purpose pressure transducers designed to provide accurate reliable, and repeatable pressure measurements in the range from 1000 Torr to 1.0 Torr of Full Scale. These instruments operate with  $\pm 15\text{VDC}$  & provide 0 to 10 VDC output linear with pressure.

## Features & Benefits

- Full Scale range as low as 1 Torr.
- Measurement total pressure directly, independent of gas composition.
- Excellent long-term stability
- Percent of Reading accuracy for more accurate output signal in lower scale of pressure range
- Compatible with earlier ACM Series, ATOVAC power supply & Readout modules.

## Dimensions

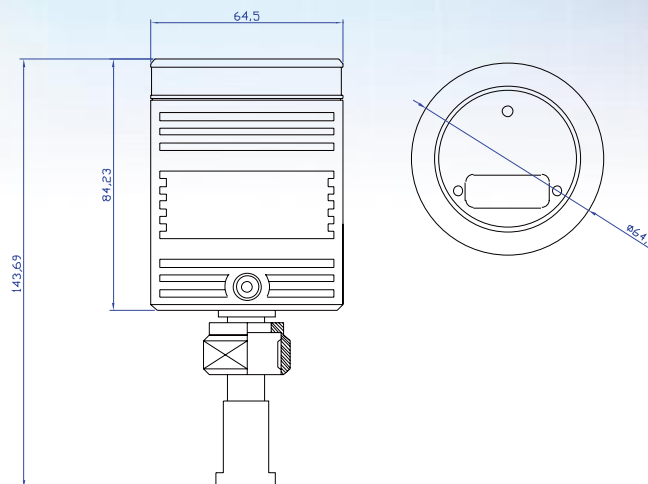

# ACM200 Capacitance Manometer

## Specifications

Pressure ranges (mmHg Full Scale)	1, 2, 10, 100, 1000
Useable measurement range	1 x 10 <sup>-4</sup> of F.S
Accuracy (non-linearity, hysteresis, and non-repeatability)	0.25% of Reading
Temperature Coefficients Zero Span	0.002% F.S/°C 0.02% Reading/°C
Ambient operating temperature range	0°C to 50°C
Materials exposed to gases	Inconel
Volume (Px side)	6.3 cc
Overpressure limit without damage	45 psia (310 kpa)
Input Required	±15VDC (±5%) @ 35 mA
Output	0 to +10VDC into ≥ 10K Ω load
Fittings	8 VCR female, NW16KF



Ürək Mah. Sedef Sitesi 4 Blok Daire:1 Ataşehir / İSTANBUL

Tel: 0216 455 66 40 Faks: 0216 455 66 41

www.novaanalitik.com info@novaanalitik.com



176-11 , Mapyeong-dong , Cheoin-gu  
Yongin-Si, Kyonggi-Do, Korea . Zip code : 449-928  
Tel : 82-31-526-0526  
Fax : 82-70-8650-0526  
Web site : <http://www.atovac.com>  
E-mail : [atovac@atovac.com](mailto:atovac@atovac.com)